

Butterfly

Fast and versatile towel folder
building on the DNA of the
renowned Tematic folder range



Optimized production by the new Butterfly series

Building on the DNA of the renowned Tematic towel folder, the new Butterfly series carries on a long tradition with experience from thousands of Tematic towel folders delivered world-wide, ensuring optimum production every day.

Increased flexibility by the new Butterfly series

The new Butterfly series has been designed to handle the complete range of towels, fitted sheets, patient garments and light uniforms depending on selection of model and options. As a result, the new Butterfly series meets all requirements of today's and tomorrow's laundry automation.

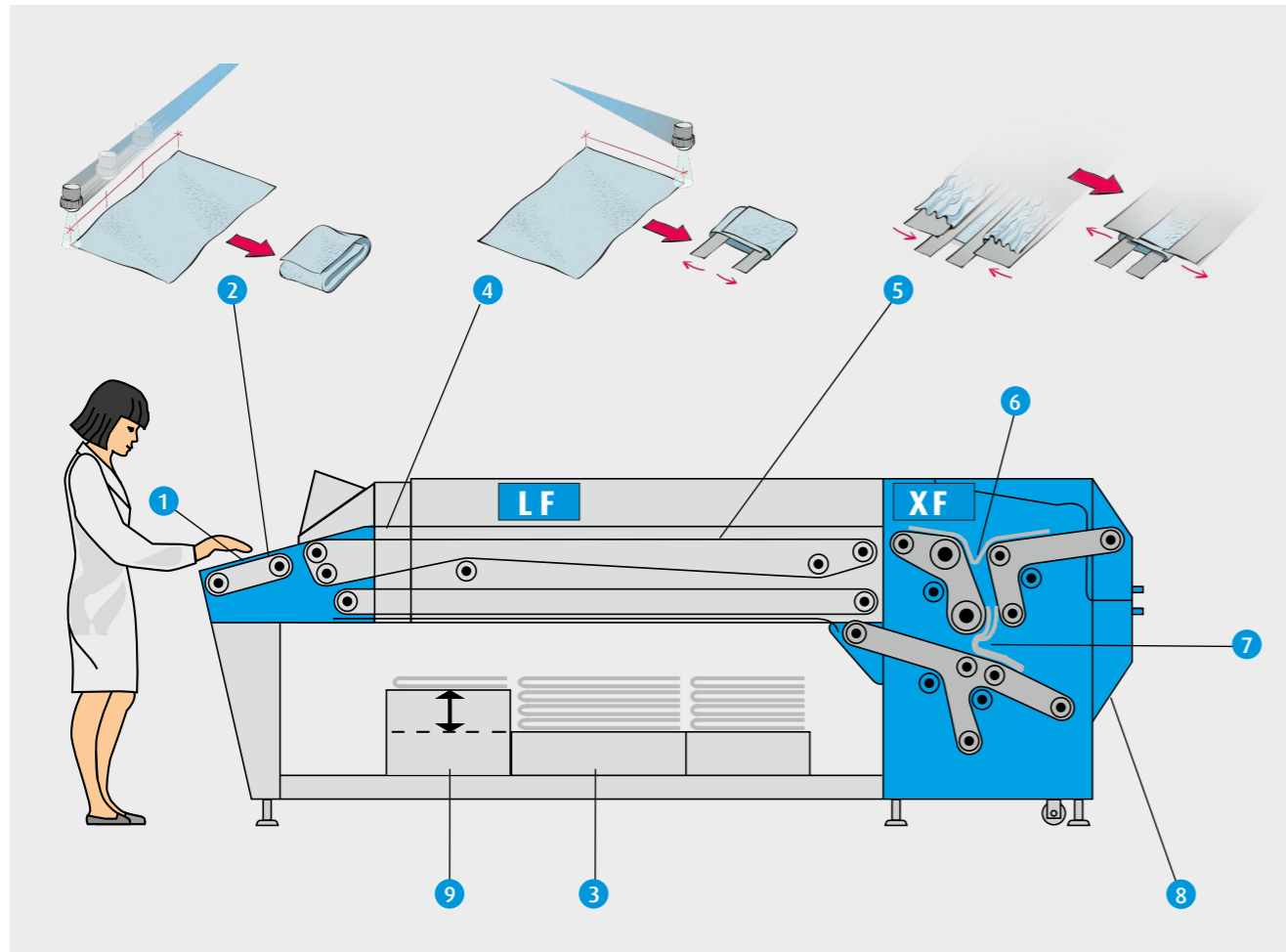

Optimum production

1 Fast feeding

The Butterfly folder is equipped with vacuum support at the inlet table ensuring fast feeding with top quality.

As an option, the inlet table can be adjusted in the height to suit each individual operator, thus ensuring the optimum ergonomic working position and speed.

2 Automatic sorting and stacking

The Butterfly folder is supplied with three photocells positioned on the feeding table, enabling automatic sorting and stacing onto pre-determined stackers **3** according to item width or feeing position. As an optional feature named the "Colibri", three vertically and three horizontally positioned photocells placed on the inlet table can be combined, providing in total six photo-cells allowing automatic folding, sorting and stacking according to program. Bypass of up to 600 mm (23.6") wide pieces for cross folding or stacking only is possible.

Increased automation

4 Optimum PPOH by AutoSelect

The AutoSelect program works by means of a photocell positioned between the inlet and the lateral folding section.

The AutoSelect program considerably increases the PPOH in mixed production, as the machine automatically measures the length of the item during feeding. Based on the length of the item, the machine automatically selects the right folding program and stacks the piece on a pre-determined stacker.

Depending on choice of options, the Butterfly folder can handle towels with a minimum size of L. 420×W. 400 mm (16.5"×15.7") and a maximum width of 1200 mm (47"). The maximum towel length is 2000 mm (79").

As an option, the Butterfly can handle towels with a length of up to 2400 mm (94"). If supplied with the optional pre-fold **10** the Butterfly folder can handle large Spa towels or blankets with a length of up to 3200 mm (126") as well.

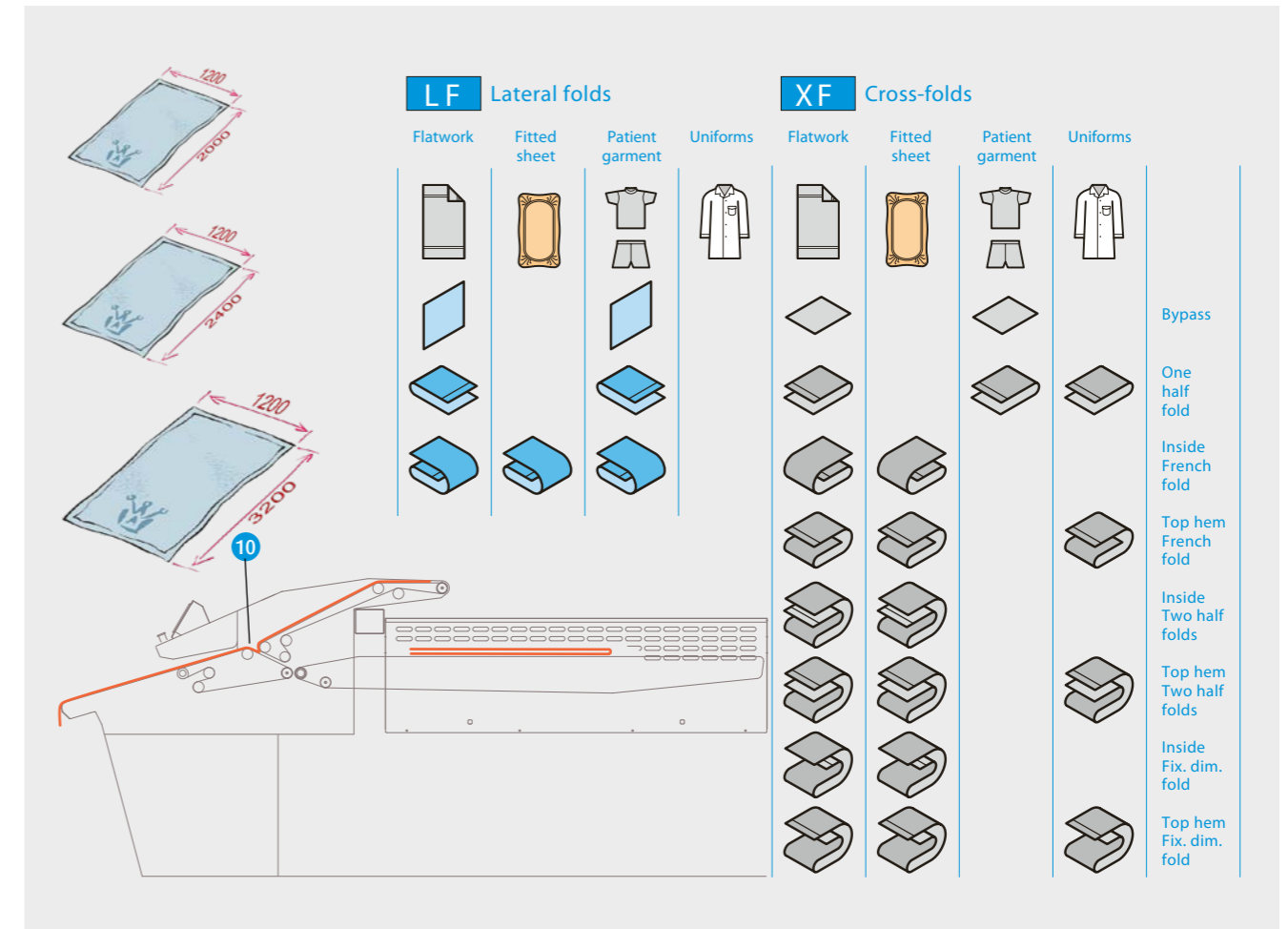

Top-quality folding

5 Fast folding by folding blades

The lateral fold is performed by folding blades folding the piece across an adjustable template. The horizontal folding movement guarantees fast folding, and the folding blades provides a stretching effect to the linen, which proves an advantage especially for heavily used terry towels and fitted sheets. On folding light uniforms, the sleeves are manually folded in before feeding. Thanks to the use of mechanical folding blades instead of air blast, the consumption of compressed air is considerably reduced.

6 Flexible 1st cross fold

The cross fold section can perform one or two cross folds as a half fold, or one French fold. The first cross fold is performed by reversing conveyor and air blast. An optional knife is recommended for light t-shirts and incontinence pads. The cross fold section is flexible and adapts automatically to the thickness of the item. Furthermore the flexibility allows a piece to be easily removed in case of a jam.

Full control

7 Optimum grip

The second cross fold is performed by a reversing conveyor and air blast providing a pressing effect to the folded piece. This technique ensures optimum grip and full control of the item, resulting in an exact fold.

8 Reject possible

By pressing the reject button at the feeding table, the piece will be rejected after the lateral folding, reducing the risk of a jam in the cross fold section.

9 Lift stacker

Each stacker is available with an optional lifting device. The lifting device lifts the stacker up to a receiving height close to the stacking flaps, which reduces the drop distance of the linen, and gives a better stacking quality as a result.

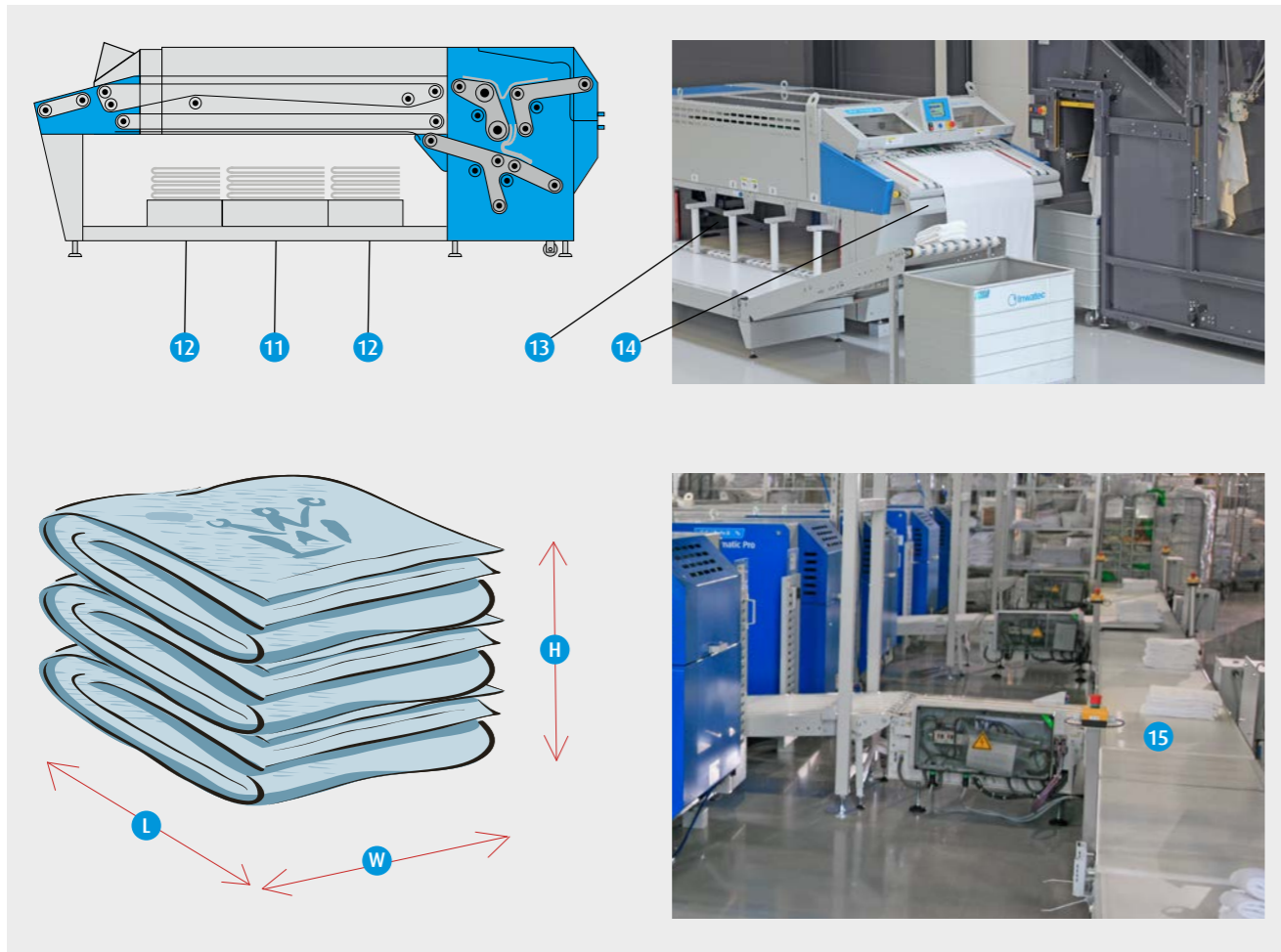

Stacking solutions

11 12 Stacking section

The stacking section provides up to four stackers with a length **L** of 470 mm (18.5"). The most sold model comprises two roll-off stackers **12** of **L** 470 mm (18.5"), with an optional stacker **11** of **L** 670 mm (26.3") positioned in the middle. Coupling of stackers is possible allowing larger pieces to be stacked.

Stacking size and position

Each stacker is designed for a stacking size of: L. 470×W. 475×H. 300 mm (L. 18.5"×W. 18.7"×H. 11.8"). Optional larger stacking is possible allowing to increase the length and width of the stacked items by 200 mm (7.8"), and the stacking height by 100 mm (3.9").

Delivery solution

13 Simplified reject conveyor

The majority of Butterfly folders are supplied with roll-off conveyors positioned after the stacker, but the folder is also available with a simplified reject conveyor developed for the high-speed package.

14 Return to operator

Return to the operator includes a roll-off conveyor delivering the stack to an inclined conveyor positioned at the side of the machine.

15 Delivery to a Jenway system

The inclined transport conveyor can be connected to a Jenway conveyor system via an optional roll-off table enabling automatic transportation of the stack to a central delivery point.

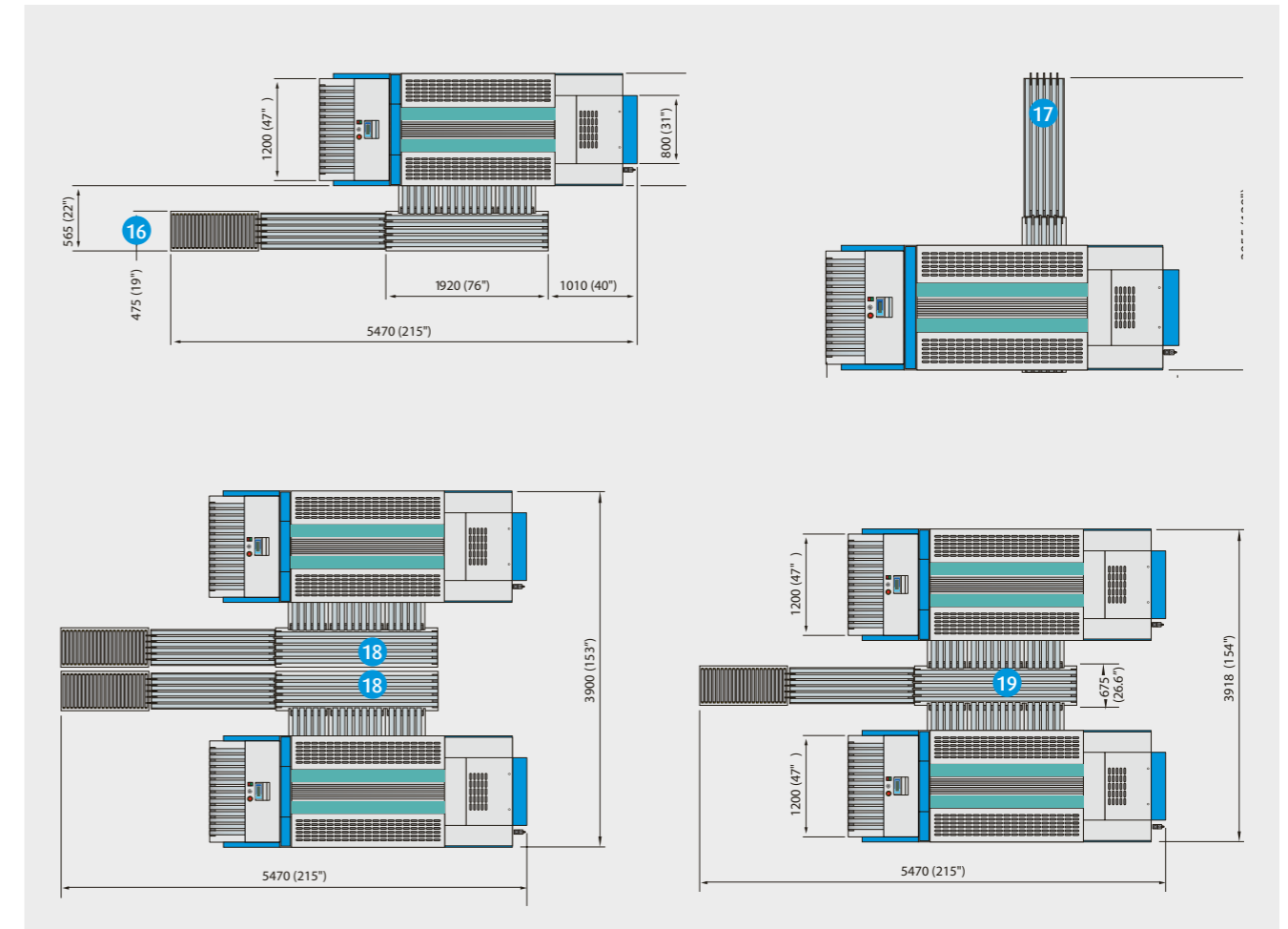

High capacity

Butterfly

The Butterfly folder ensures the optimum stacking quality thanks to the Butterfly folder. In this configuration, the Butterfly folder has a cycle time of 2.25 seconds allowing a theoretical maximum capacity of up to 1600 pcs/hr. without sorting, and up to 1200 pcs/hr. when sorting three mixed sizes of towels on three stackers.

Increased capacity

As an option, the Butterfly folder is available with a high-speed package incorporating a simple and fast stacking conveyor. As a result, the cycle time of the machine will be reduced to 1.8 second when folding small or medium size towels without sorting.

Layout examples

16 Outlet with return to operator

The stack will stop on the delivery conveyor or on an optional roller conveyor positioned close to the operator.

17 Outlet to an incline conveyor

This solution eliminates the need for a Roll-Off conveyor as the stack will be dropped directly onto the delivery conveyor.

18 Twin solution

The Twin solution comprises two separate Butterfly folders equipped with their own delivery conveyors placed in a mirror configuration to save space. Thanks to the two individual machines, this solution is faster and cheaper than the Master/Slave solution.

19 Master/Slave solution

The Master/Slave solution comprises two Butterfly folders sharing one delivery conveyor to save space.



Fast operation

Thanks to the low cycle times between 1.8 and 3.6 seconds depending on type of linen and choice of options, the Butterfly folder is faster than the operator.

Optimized production by the Thor separator 20

To optimize the utilization of the capacity of the Butterfly folder, the "THOR" separator has been developed.

Thanks to the continuous supply of separated towels presented in the optimum ergonomic height by the THOR separator, the production per operator hour can be considerably increased.

Installation

JENSEN is pleased to assist you in planning your laundry by providing excellent advice, layouts and technical data. Authorized JENSEN engineers or JENSEN distributors should carry out the installation to ensure that it is performed correctly.

Service

In addition, JENSEN provides an extraordinary after-sales service through a worldwide network of highly qualified Sales and Service Centres and distributors, all with their own maintenance and spare parts services.

Call us...

JENSEN provides a complete range of heavy-duty equipment for the laundry industry, delivered and installed according to your specifications. Please do not hesitate to contact us for further advice and information, or visit

www.jensen-group.com

Local contact



www.jensen-group.com



Explore our equipment on  **YouTube**
www.youtube.com/jensengroupcom